

RoHS



- Aluminium-Alloy IP65 single point load cell
- Colourless anodized
- Suitable for belt, pricing and platform scales



Capacity	Accuracy	Part-Number
50 kg	C3	L6F-C3-50kg-3B6
100 kg	C3	L6F-C3-100kg-3B6
150 kg	C3	L6F-C3-150kg-3B6
200 kg	C3	L6F-C3-200kg-3B6
250 kg	C3	L6F-C3-250kg-3B6
500 kg	C3	L6F-C3-500kg-3B6
750 kg	C3	L6F-C3-750kg-3B6
1000 kg	C3	L6F-C3-1000kg-3B6
2000 kg	C3	L6F-C3-2000kg-3B6

Specification:

Accuracy class	OIML R60 C3			
Output sensitivity (= FS)	mV/V	2.0 ± 0.2		
Maximum capacity (E _{max})	kg	50, 100, 150, 200	250, 500	750, 1000, 2000
Maximum number of load cell intervals (n _{LC})		3000		
Ratio of minimum LC verification interval Y = E _{max} / V _{min}		7000		
Combined Error	%FS	± 0.0200		
Minimum dead load	kg	0		
Safe overload	of E _{max}	150 %		
Ultimate overload	of E _{max}	300 %		
Zero balance	of FS	< ± 2.0 %		
Excitation, recommended voltage	V	5 ~ 12		
Excitation maximum	V	18		
Terminal resistance, input	Ω	406 ± 6		
Terminal resistance, output	Ω	350 ± 3		
Maximum platform size	mm x mm	600x600	600 x 800	1200 x 1200
Insulation impedance	MΩ	≥5000 (at 50VDC)		
Temperature range, compensated	°C	-10 ~ +40		
Temperature range, operating	°C	-35 ~ +65		
Element material		Aluminium		
Recommended torque on fixation bolts	Nm	M12:10		M16:160
Ingress Protection (according to EN 60529)		IP65		

Outline Dimensions in mm (inch)

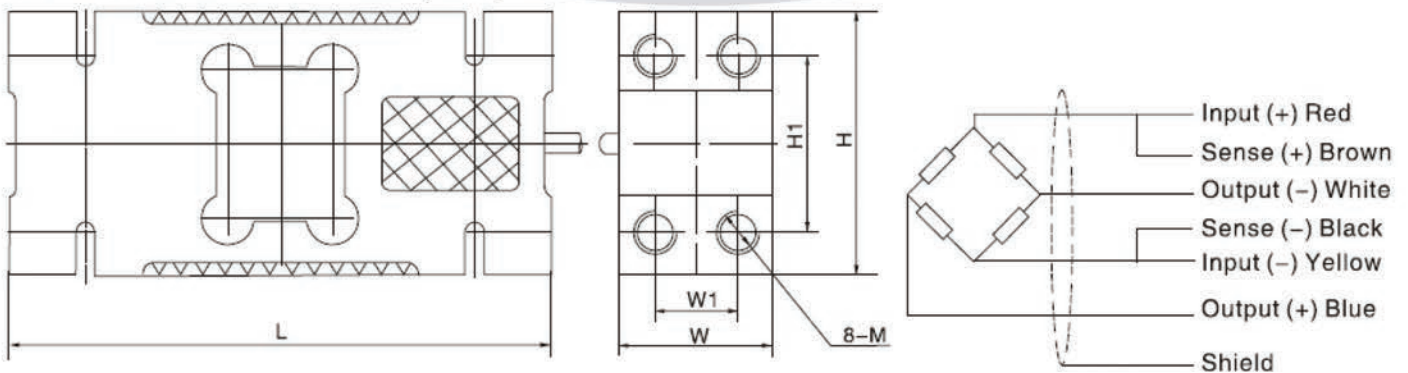

Dimension Capacity	H	H1	L	W	W1	M
50 - 200kg	75(2.95)	50(1.97)	156(6.14)	44(1.73)	24(0.94)	M12-7H Depth20(0.79)
250 - 500kg	95(3.74)	70(2.76)	146(5.75)	60(2.36)	36(1.42)	M12-7H Depth18(0.71)
750 - 2000kg	125(4.92)	95(3.74)	176(6.93)	76(2.99)	46(1.81)	M16-7H Depth20(0.79)

Wiring:

Shielded, 6 conductor cable
 Cable jacket is PVC.
 Cable length: 3 ± 0.1m
 Cable diameter: 6.2 ± 0.2mm
 Shield not connected to element